

# 213 SERIES

## Horizontal Hold Down Clamps | Product Overview

### Features:

- Low profile
- Large handle clearance in the open position
- Available in stainless steel
- BLK models feature a black, non-reflective finish

### Applications:

- Assembly
- Checking fixtures
- Closures
- Woodworking

### Also Available:

See page MC-ACC-1 for accessories  
Accommodates M5 or #10 spindle accessory

**213-U**  
Flanged Base  
U-Bar



**213-U-LS-BLK** ⓘ  
Blackout Series  
Flanged Base  
U-Bar



**213-USS**  
Flanged Base  
U-Bar, Stainless  
Steel



**213-UB**  
Straight Base  
U-Bar



**213-UB-LS-BLK** ⓘ  
Blackout Series  
Straight Base  
U-Bar



**213-U-L** ⓘ  
Flanged Base  
Open Bar



**213-U-L-BLK** ⓘ  
Flanged Base  
Open Bar



**213-UB-L** ⓘ  
Straight Base  
Open Bar



**213-UB-L-BLK** ⓘ  
Blackout Series  
Straight Base  
Open Bar



ⓘ This item is available upon request

## Technical Information

Model	Max. Holding Capacity	Clamp Bar Opening (+10°)	Handle Opening (+10°)	Weight	Accessories (Supplied)	
					Spindle Assembly	Flanged Washers
213-U	670 N [150 lbf]	90°	60°	0,08kg [0.17lb]	213208-M	102111
213-U-LS-BLK ⓘ					--	102111-BLK
213-USS					201943-M	102911
213-UB					213208-M	102111
213-UB-LS-BLK ⓘ					--	102111-BLK
213-U-L ⓘ						102111
213-U-L-BLK ⓘ						102111-BLK
213-UB-L ⓘ						102111
213-UB-L-BLK ⓘ						102111-BLK

ⓘ This item is available upon request

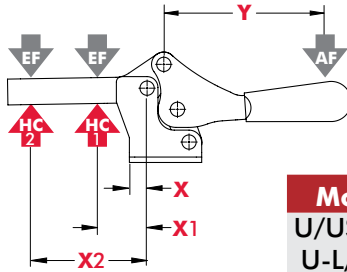

Model	X	X1	X2	Y	±HC1	±HC2	±EF(X1):AF	±EF(X2):AF
U/USS/UB	[0.36]	[0.75]	[1.63]	[1.81]	[150lbf.]	[70lbf.]	7:1	3:1
U-L/UB-L	9,3	19	41,4	46	670N	310N		

Dimensions shown "mm [inch]" ± HC = Holding Capacity, EF = Exerting Force, AF = Applied Force  
See page MC-TEC-4 for additional information.

### Dimensions | -U/-USS/-UB

#### 213-U Flanged Base U-Bar

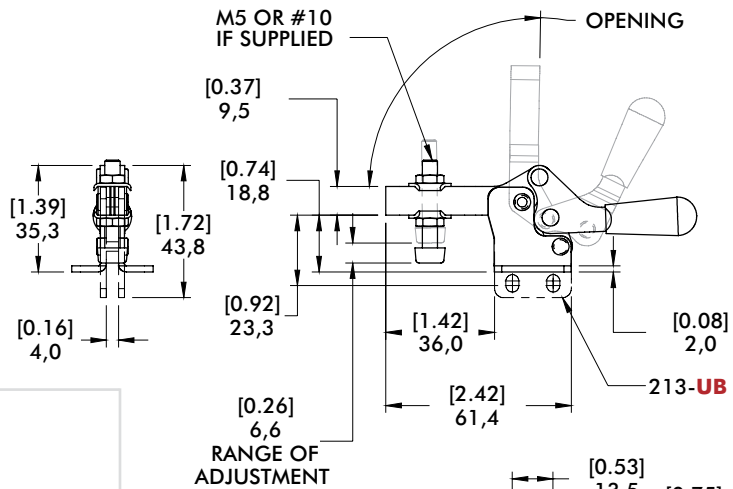
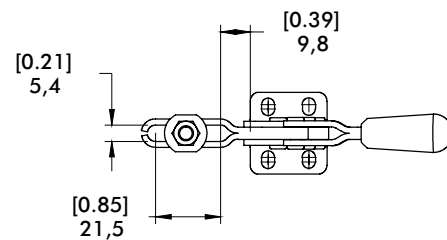

### Series 213 Open Bar Options



#### Flanged Base Model 213-U-L ⓘ

See page MC-ACC-7 for Complete offering of Open bar accessories

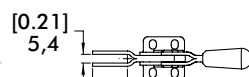

#### Straight Base Model 213-UB-L ⓘ

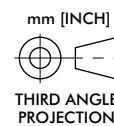
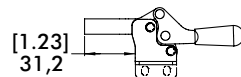

# 217 SERIES

## Horizontal Hold Down Clamps | Product Overview

### Features:

- Low profile
- Large handle clearance in the open position
- Available in stainless steel
- BLK models feature a black, non-reflective finish

### Applications:

- Assembly
- Checking fixtures
- Closures
- Woodworking

### Also Available:

See page MC-ACC-1 for accessories  
Accommodates M6 or 1/4" spindle accessory

**217-U**  
Flanged Base  
U-Bar

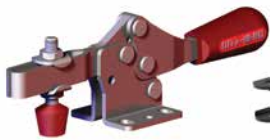

**217-U-LS-BLK** ⓘ  
Blackout Series  
Flanged Base  
U-Bar



**217-USS**  
Flanged Base  
U-Bar, Stainless  
Steel



**217-UB**  
Straight Base  
U-Bar



**217-UB-LS-BLK** ⓘ  
Blackout Series  
Straight Base  
U-Bar



**217-U-L** ⓘ  
Flanged Base  
Open Bar

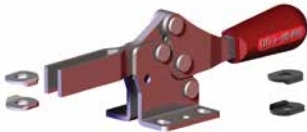

**217-U-L-BLK** ⓘ  
Flanged Base  
Open Bar



**217-UB-L** ⓘ  
Straight Base  
Open Bar



**217-UB-L-BLK** ⓘ  
Blackout Series  
Straight Base  
Open Bar



ⓘ This item is available upon request

## Technical Information

Model	Max. Holding Capacity	Clamp Bar Opening (+10°)	Handle Opening (+10°)	Weight	Accessories (Supplied)	
					Spindle Assembly	Flanged Washers
217-U	900 N [200 lbf]	91°	61°	0,18kg [0.40lb]	202208-M	215105
217-U-LS-BLK ⓘ					--	215105-BLK
217-USS	1110 N [250 lbf]				202943-M	215105
217-UB					202208-M	215105
217-UB-LS-BLK ⓘ						215105-BLK
217-U-L ⓘ	900 N [200 lbf]					215105
217-U-L-BLK ⓘ					--	215105-BLK
217-UB-L ⓘ						215105
217-UB-L-BLK ⓘ						215105-BLK

ⓘ This item is available upon request

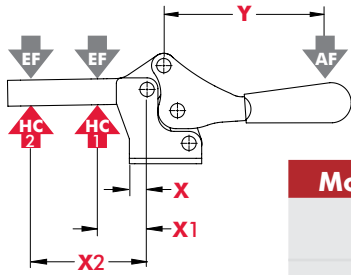

Model	X	X1	X2	Y	±HC1	±HC2	±EF(X1):AF	±EF(X2):AF
U					[200lb.f.] 900N	[80lb.f.] 360N		
USS	[0.53] 13,5	[1.13] 28,6	[2.63] 66,8	[2.93] 74,5	[250lb.f.] 1110N	[100lb.f.] 440N	7:1	3:1
UB/U-L/ UB-L					[200lb.f.] 900N	[80lb.f.] 360N		

Dimensions shown "mm [inch]" ± HC = Holding Capacity, EF = Exerting Force, AF = Applied Force  
See page MC-TEC-4 for additional information.

### Dimensions | -U/-USS/-UB

#### Series 217 Open Bar Options



**Flanged Base**  
Model  
**217-U-L**



**Straight Base**  
Model  
**217-UB-L**

See page MC-ACC-7 for  
Complete offering of  
Open bar accessories

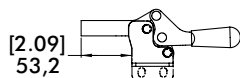
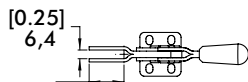

#### 217-U Flanged Base U-Bar

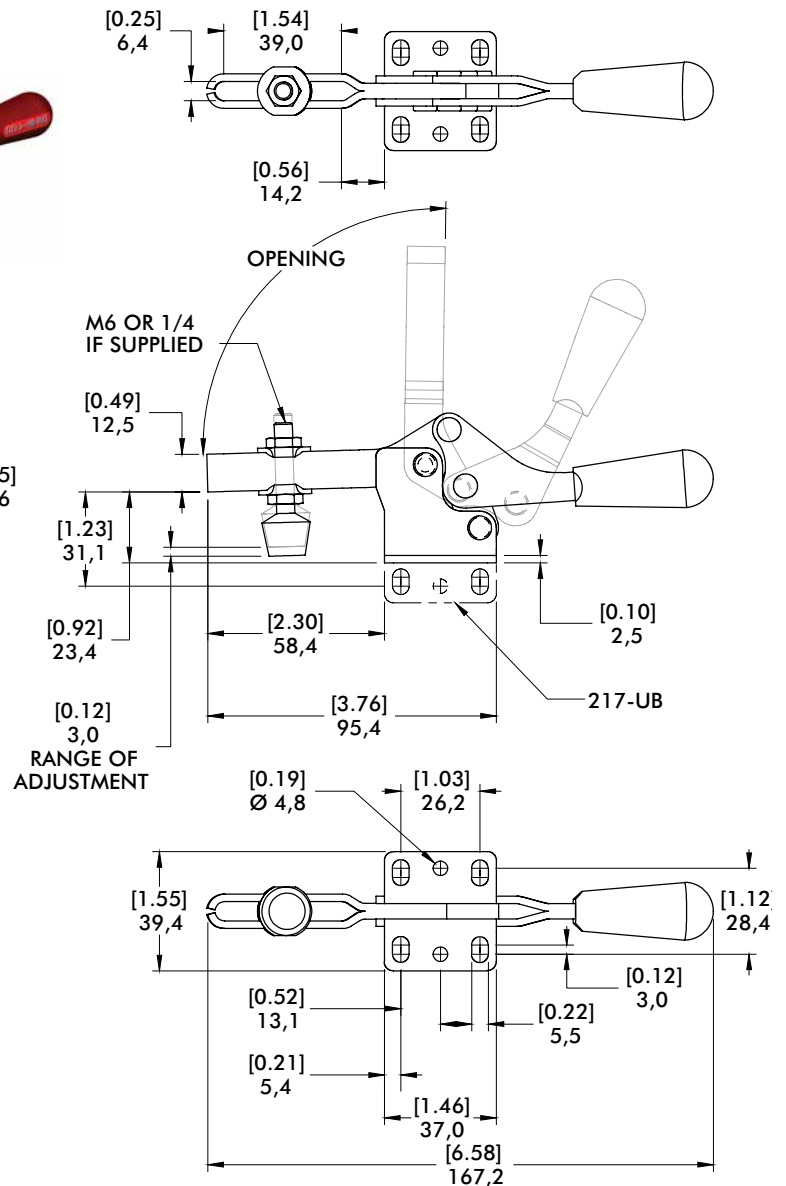
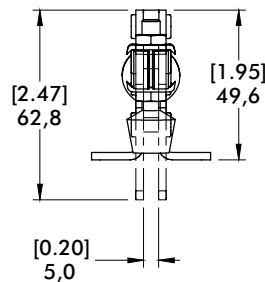
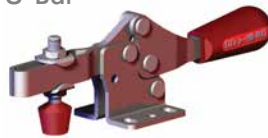

mm [INCH]



# 227 SERIES

## Horizontal Hold Down Clamps | Product Overview

### Features:

- Low profile
- Large handle clearance in the open position.
- Available in stainless steel
- BLK models feature a black, non-reflective finish

### Applications:

- Assembly
- Checking fixtures
- Closures
- Woodworking

### Also Available:

See page MC-ACC-1 for accessories  
Accommodates M6 or 5/16" spindle accessory

**227-U**  
Flanged Base  
U-Bar

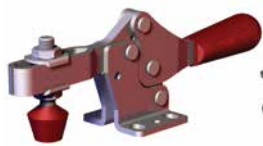

**227-U-LS-BLK** ⓘ  
Blackout Series  
Flanged Base  
U-Bar



**227-USS**  
Flanged Base  
U-Bar, Stainless  
Steel



**227-UB**  
Straight Base  
U-Bar



**227-UB-LS-BLK** ⓘ  
Blackout Series  
Straight Base  
U-Bar



**227-U-L** ⓘ  
Flanged Base  
Open Bar



**227-U-L-BLK** ⓘ  
Blackout Series  
Flanged Base  
Open Bar



**227-UB-L** ⓘ  
Straight Base  
Open Bar



**227-UB-L-BLK** ⓘ  
Blackout Series  
Straight Base  
Open Bar



ⓘ This item is available upon request

## Technical Information

Model	Max. Holding Capacity	Clamp Bar Opening (+10°)	Handle Opening (+10°)	Weight	Accessories (Supplied)	
					Spindle Assembly	Flanged Washers
227-U	2220 N [500 lbf]	91°	56°	0,31kg [0.68lb]	225208-M	507107
227-U-LS-BLK ⓘ					--	507107-BLK
227-USS	2670 N [600 lbf]				-207943-M	507907
227-UB	2220 N [500 lbf]				225208-M	507107
227-UB-LS-BLK ⓘ					--	507107-BLK
227-U-L ⓘ					--	507107
227-U-L-BLK ⓘ					--	507107-BLK
227-UB-L ⓘ					--	507107
227-UB-L-BLK ⓘ		--	507107-BLK			

ⓘ This item is available upon request

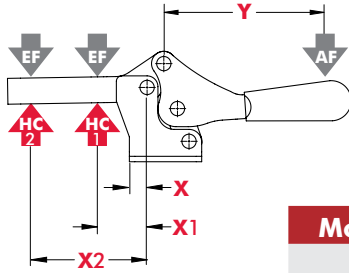

Model	X	X1	X2	Y	±HC1	±HC2	±EF(X1):AF	±EF(X2):AF
U					[500lbf.] 2220N	[225lbf.] 1000N		
USS	[0.39] 10,0	[1.25] 31,8	[2.75] 70,0	[3.58] 91,0	[600lbf.] 2670N	[270lbf.] 1200N	8:1	3:1
UB/U-L/ UB-L					500lbf.] 2220N	[225lbf.] 1000N		

Dimensions shown "mm [inch]" ± HC = Holding Capacity, EF = Exerting Force, AF = Applied Force  
See page MC-TEC-4 for additional information.

### Dimensions | -U/-USS/-UB

**227-U**  
Flanged Base  
U-Bar

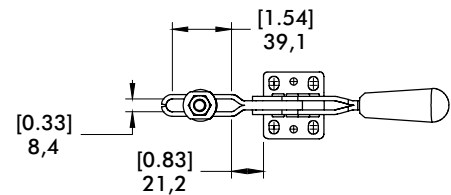

### Series 227 Open Bar Options



Flanged Base  
Model  
**227-U-L** ⓘ

See page MC-ACC-7 for Complete offering of Open bar accessories

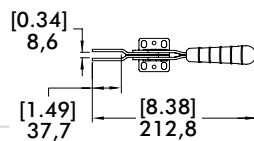

Straight Base  
Model  
**227-UB-L** ⓘ

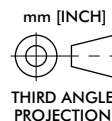
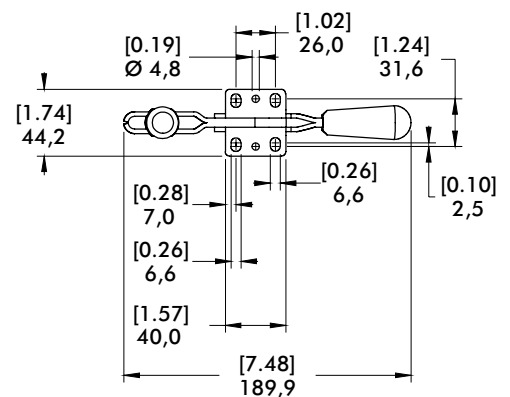
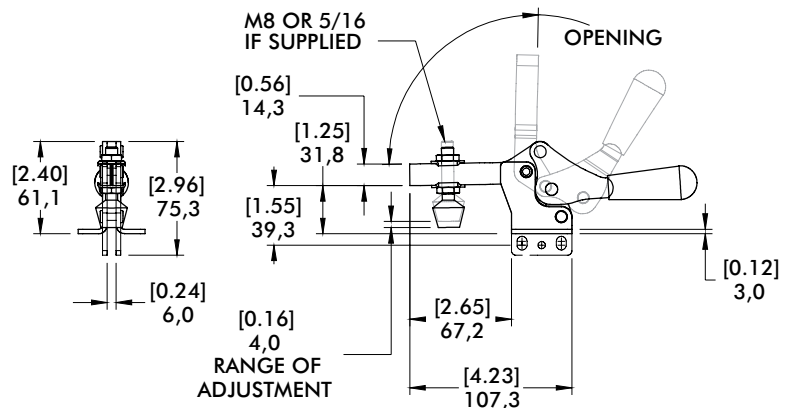
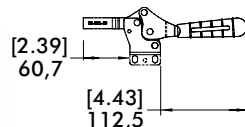

# 237 SERIES

## Horizontal Hold Down Clamps | Product Overview

### Features:

- Low profile
- Large handle clearance in the open position.
- Available in stainless steel

### Applications:

- Assembly
- Checking fixtures
- Welding

### Also Available:

See page MC-ACC-1 for accessories

Accommodates M10 or 3/8" spindle accessory

**237-U**  
Flanged Base  
U-Bar

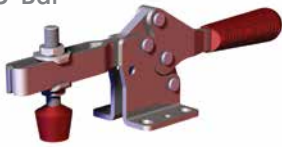

**237-USS** ⓘ  
Flanged Base  
U-Bar, Stainless  
Steel



## Technical Information

Model	Max. Holding Capacity	Clamp Bar Opening(+10°)	Handle Opening (+10°)	Weight	Accessories (Supplied)	
					Spindle Assembly	Flanged Washers
237-U	3340 N [750 lbf]	93°	59°	0,73kg [1.60lb]	240208-M	235106
237-USS ⓘ	3780 N [850 lbf]				237943-M	235906

ⓘ This item is available upon request

## Holding Capacities

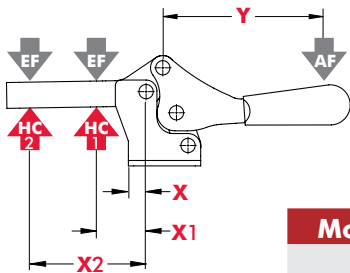

Model	X	X1	X2	Y	±HC1	±HC2	±EF(X1):AF	±EF(X2):AF
U	[0.81]	[1.75]	[4.50]	[5.25]	[750lbf.] 3340N	[290lbf.] 1290N	6:1	2:1
USS	20,6	44,5	114,3	133,3	[850lbf.] 3780N	[330lbf.] 1470N		

Dimensions shown "mm [inch]" ± HC = Holding Capacity, EF = Exerting Force, AF = Applied Force  
See page MC-TEC-4 for additional information.

**237-U**  
Flanged Base  
U-Bar

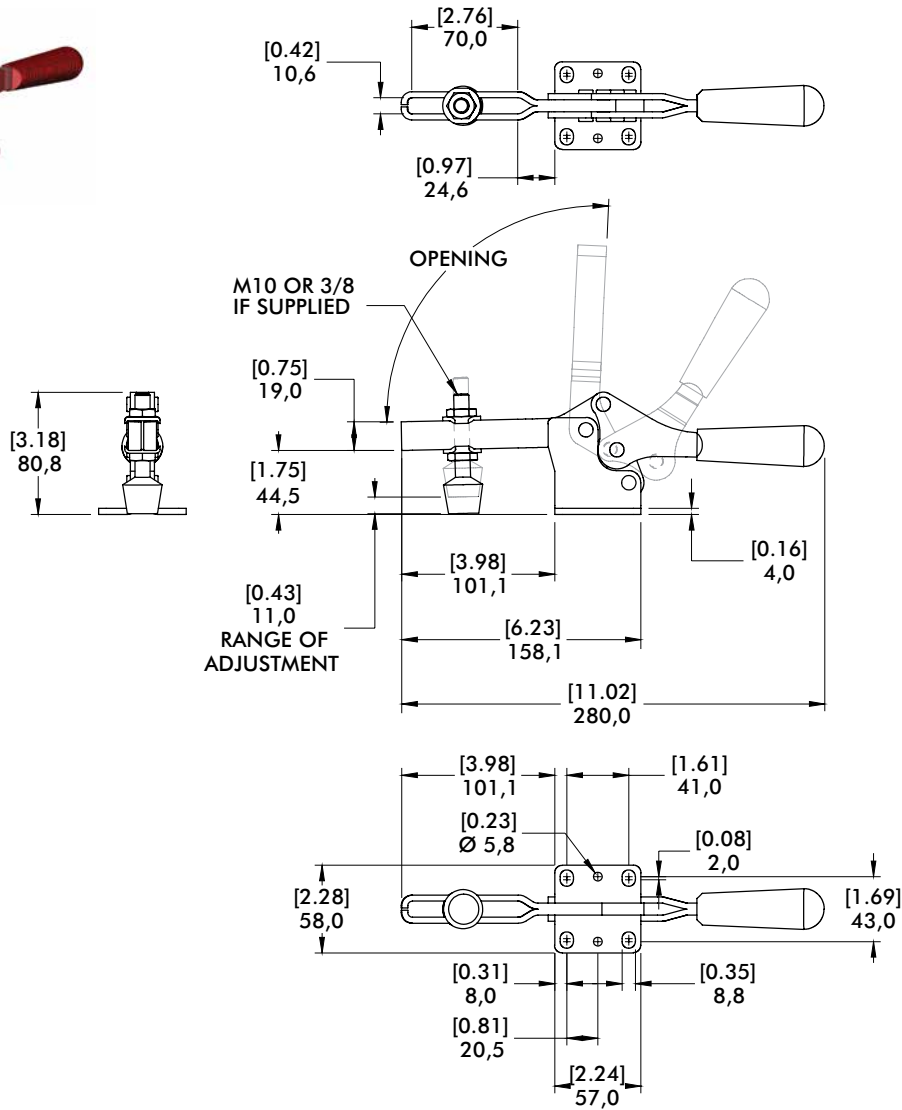



# 245 SERIES

## Horizontal Hold Down Clamps | Product Overview

### Features:

- Low profile
- Large handle clearance in the open position.

### Applications:

- Assembly
- Checking fixtures
- Welding

### Also Available:

See page MC-ACC-1 for accessories  
Accommodates M12 or 1/2" spindle accessory

### 245-U Flanged Base U-Bar



## Technical Information

Model	Max. Holding Capacity	Clamp Bar Opening (+10°)	Handle Opening (+10°)	Weight	Accessories (Supplied)	
					Spindle Assembly	Flanged Washers
245-U	4450 N [1000 lbf]	105°	74°	1,32kg [2.90lb]	247208-M	247109

## Holding Capacities

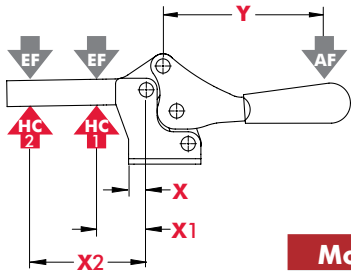

Model	X	X1	X2	Y	±HC1	±HC2	±EF(X1):AF	±EF(X2):AF
U	[0.50] 12,7	[2.00] 50,8	[5.00] 127	[6.09] 154,7	[1000lbf.] 4450N	[400lbf.] 1780N	11:1	5:1

Dimensions shown "mm [inch]" ‡ **HC** = Holding Capacity, **EF** = Exerting Force, **AF** = Applied Force  
See page MC-TEC-4 for additional information.

**245-U**  
Flanged Base  
U-Bar

